



# STRATOGISTICS

By : Group 8



## OUR TEAM

Fakhira Alani  
Aishah  
Hui Liang  
Afrina  
Nazirah

Amiera  
Anis Aisyah  
Maisarah  
Alissa  
Fatin

Farah  
Aliah  
Anis  
Safiah  
Siti Aisyah

# WAREHOUSE

- Large building or facility used for storing goods and materials

## WHY CHOOSE THE CONCEPT OF "WAU BULAN"?

- Strong Global Presence
- Cultural Significance
- Aesthetic Appeal
- Sustainability and Innovation

# EXTERIOR DESIGN



# INTERIOR DESIGN

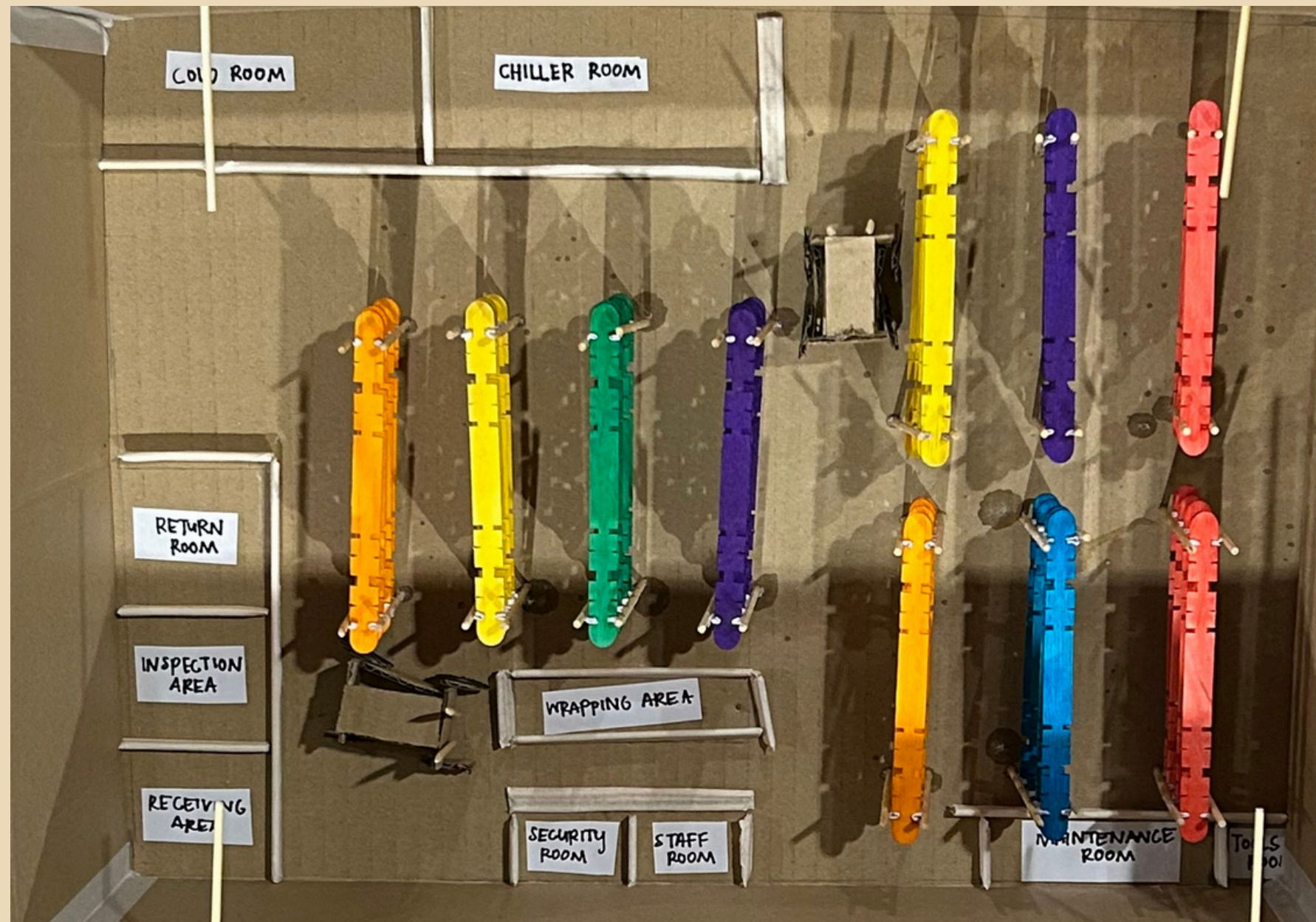



SDG



# ✓ SERVICES PROVIDED

- **Receiving Area (Inbound)** – checked before moving to the Inspection Area
- **Inspection Area** – for compliance and quality assurance
- **Cold & Frozen Storage** – stored here under strict HACCP guidelines
- **Return Room** – handling defective or returned items, reducing processing delays
- **Wrapping Area** – securely packaged before dispatch
- **Outbound Section** – for distribution, ensuring a smooth flow



# KEY CRITERIA

- ✓ **Functional Design** – Designated areas for receiving, inspection, storage, and outbound processes helps prevent congestion.
- ✓ **Space Utilization** – Incorporate vertical storage solutions and automated systems

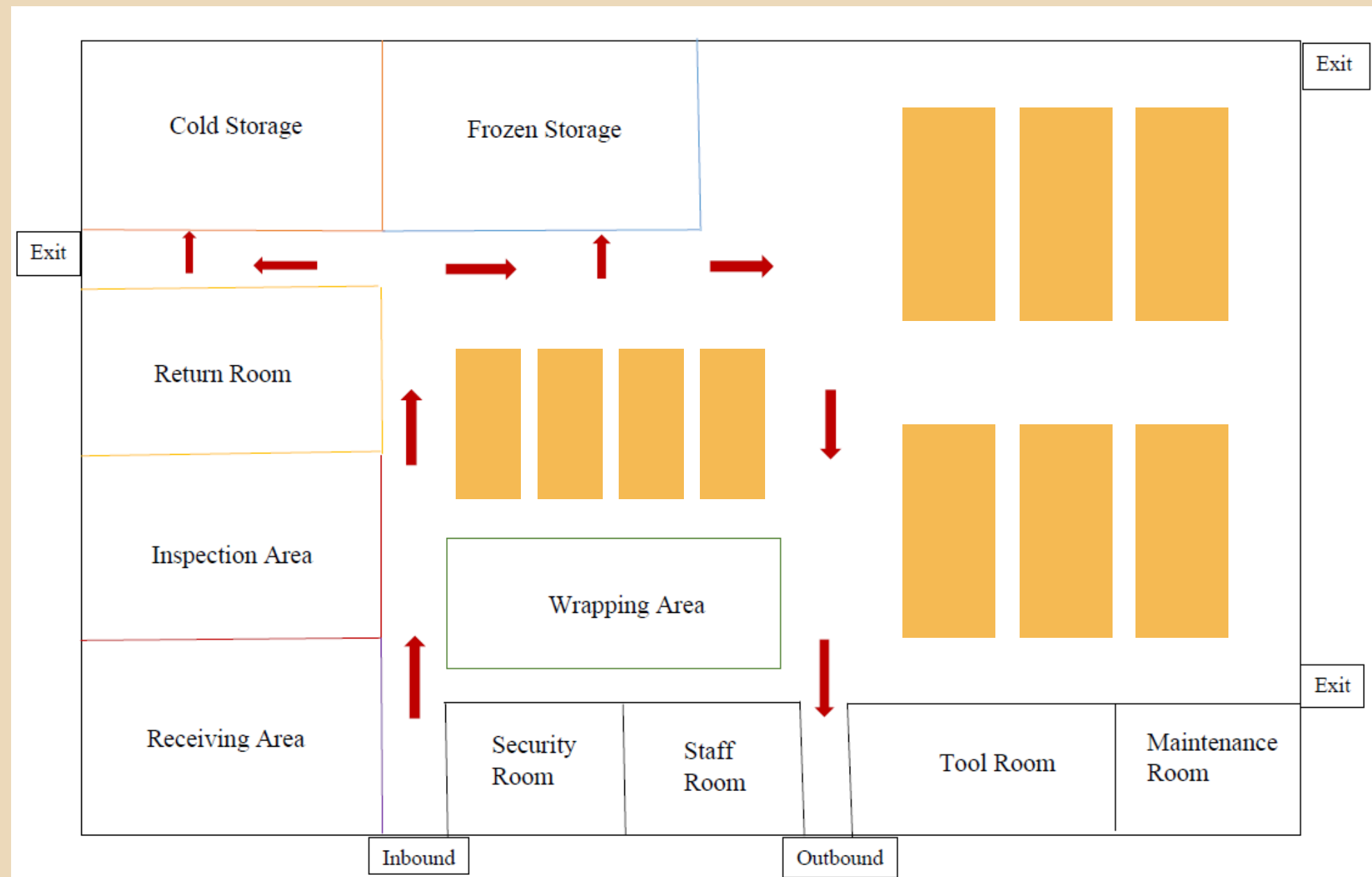

# KEY CRITERIA

- ✓ **Safety & Compliance** – We adhere to HACCP to maintain food-grade storage safety and HIRARC to mitigate workplace hazards.
- ✓ **Technology Integration** – Smart systems like RFID tracking, IoT sensors, and Automated Guided Vehicles (AGVs)
- ✓ **Sustainability** – Our warehouse utilizes renewable energy sources, water recycling systems, and eco-friendly materials

# ✔ INTEGRATED SYSTEM

- **Warehouse Management System (WMS)** : Automates inventory tracking, order processing, and stock visibility.
- **Internet of Things (IoT) Sensors** : Monitor temperature, humidity, and security, particularly for cold and frozen storage compliance.
- **Automated Picking Systems** : Reduce manual labor while increasing order accuracy and speed.
- **AI-powered Data Analytics** : Predict demand patterns, prevent stock shortages, and optimize inventory levels.

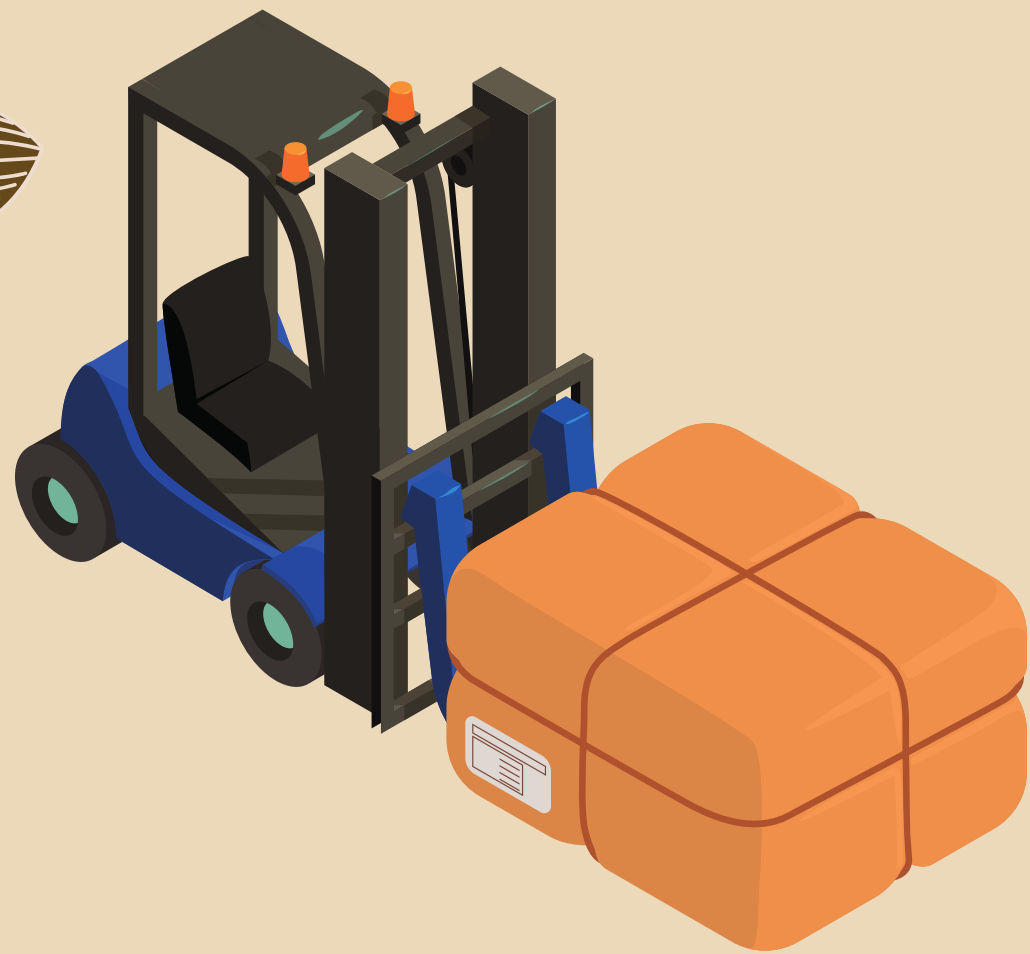

# CONCLUSION

In conclusion, our warehouse is more than a storage space. It combines Malaysia's cultural identity with modern logistics needs.

By prioritizing sustainability, technology, safety, and efficiency, we have created a future-ready warehouse that improves operations and supports global sustainability.



*Thank You*

